



Larry A. Seckel
CRS, CRB, GRI

Lakefront / Canal Frontage Zoned for 10 units per acre

156± ACRES

- 3,800± ft. of Lake frontage on Walk-in-Water (Weohyakapka)
- 3,200± ft. of Canal Frontage
- Concept Proposal preliminary plan has been submitted to the county for a 9 hole golf course, clubhouse, swimming pool, and fishing pier. The development will provide for 399 units of 50ft. X 75ft Manufactured Home Lots, 264 unit of 45ft. X 60ft. Park model RV lots, and 36 unites 35ft X 80ft. Pull through RV Lots.
- Property between three large apartment complexes of about 1100± units.

Larry A. Seckel

290 Cypress Gardens Blvd

Winter Haven, Florida 33884

"Trusted Name In Real Estate"

Office: 1-941-294-7541

Fax: 1-941-299-9523

E-Mail:

LarryRealEstate@msn.com

Web Site: www.

RealEstateFlorida.net

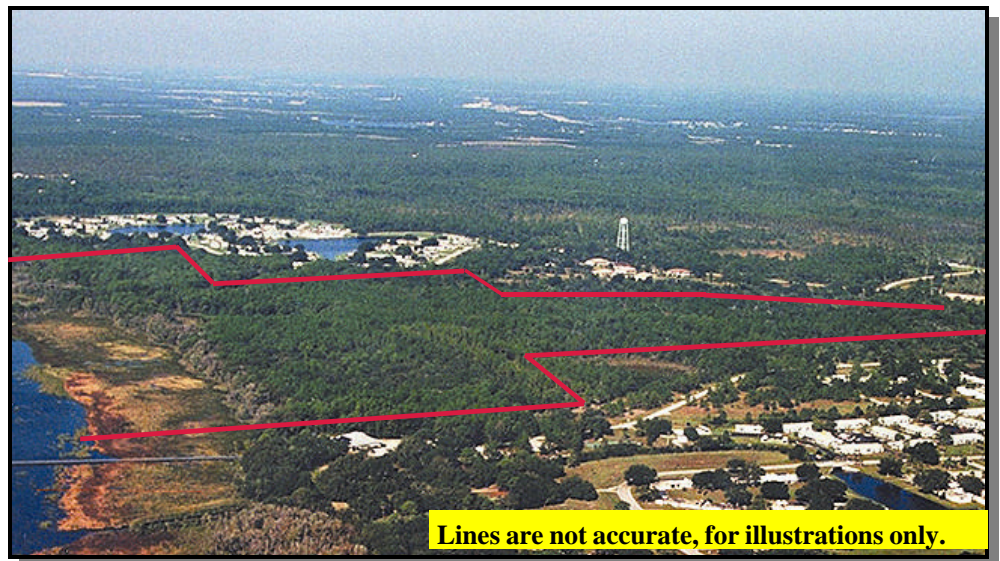

Price: \$1,250,000

Direction: Southwest corner of Leisure Lane West and Doherty Drive, north of Lake Walk-in-Water, Lake Haven Acres, approximately nine miles east of Lake Wales, in Sec. 21, Twn. 30, Rng. 29

Utilities: Area is served by two local volunteer fire departments. Lake Wales Utilities, a county franchised utility, has told the owner that they have the capacity to serve the proposed development with water and sewer.



Every effort has been made to compile this information with the highest degree of accuracy; however, it is submitted subject to unintentional errors or omissions and price change without notice.